

## Kurling for Kids 2015

### Sugita Head Frame

This neurosurgery workstation is used to stabilize the patient's head during neurosurgery. Especially in pediatrics, this six point fixation station allows maximum support and stability throughout the procedure.

With the Sugita head frame, the surgeon has the freedom to position the child's head to a precise angle, which increases precision during microneurosurgery. Neurosurgeons depend on the stability of the patient, the minutia of the medical team as well as the stability of their equipment. With the Sugita head frame, children are stabilized and fixed so that the surgeon can proceed without worry of sudden involuntary movements.



### Year 4 of the Naming Opportunity at the New Children's Hospital (\$300,000 pledged over 5 years)

"Kurling for Kids" Playroom on the Medical/Surgical Ward - Location: 8<sup>th</sup> Floor, Pavillion B, Size: 14.29 m<sup>2</sup> (154 ft<sup>2</sup>)



Plan of 8th floor medical/surgical unit showing location of playroom

The medical/surgical pediatric patient care units will provide high-quality care to general medical and surgical patients who require admission to the hospital. The age group that will be admitted includes those from infant through age 18. This floor will accommodate hospitalized patients, as well as patients admitted to the short stay unit directly from the Emergency Department. All 34 patient rooms will be single, with private washrooms and place for a parent to spend the night. The projected occupancy rate on the wards is about 85%.

As this unit will be running on a 24-hour basis, the child life specialists will have the opportunity to organize a multitude of activities for the patients, including arts & crafts, movie nights and readings, all of which will cater to various age groups. This enclosed, dedicated space will be equipped with toys, books, computer workstations, a sink and adjacent space for storage.

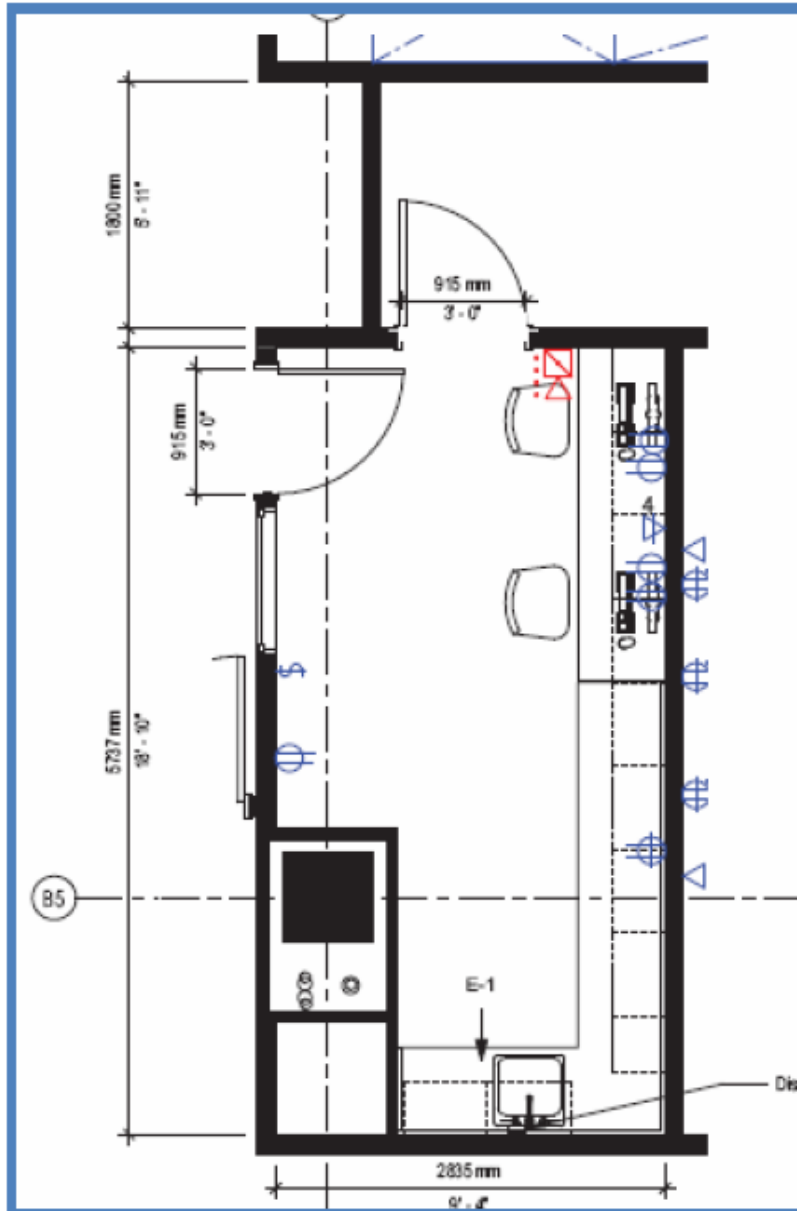

Layout of the Kurling for Kids play room